

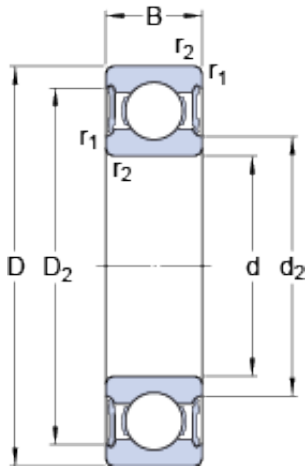

# BEARING CORP.OF AMERICA



## 6309-2RS1TN9/HC5C3WT SKF Hybrid Deep Groove Ball Bearings

Bearing No. 6309-2RS1TN9/HC5C3WT

6309-2RS1TN9/HC5C3WT Bearing 2D drawings and 3D CAD models

Size	100x45x15 mm
Bore Diameter	100 mm
Outer Diameter	45 mm
Width	15 mm
d	45 mm
D	100 mm
B	15 mm
d <sub>2</sub>	54 mm
D <sub>2</sub>	86.7 mm
d <sub>a</sub> - min.	54 mm
d <sub>a</sub> - max.	62.1 mm
D <sub>a</sub> - max.	91 mm
r <sub>a</sub> - max.	1.5 mm
Basic dynamic load rating - C	16.8 kN
Basic static load rating - C <sub>0</sub>	7.8 kN
Fatigue load limit - P <sub>u</sub>	0.335 kN
Reference speed	40000 r/min
Limiting speed	22000 r/min
Calculation factor - k <sub>r</sub>	0.025
Calculation factor - f <sub>0</sub>	12.4
Category	Single Row Ball Bearings
Inventory	0.0
Manufacturer Name	SKF
Minimum Buy Quantity	N/A



## BEARING CORP.OF AMERICA

Weight / Kilogram	0.752
Product Group	B00308
Enclosure	2 Seals
Precision Class	ABEC 1   ISO P0
Maximum Capacity / Filling Slot	No
Rolling Element	Ball Bearing
Snap Ring	No
Internal Special Features	Silicon Nitride Rolling Element   Electrical Insulated
Cage Material	Polyamide
Enclosure Type	Contact Seal
Internal Clearance	C3-Loose
Inch - Metric	Metric
Long Description	45MM Bore; 100MM Outside Diameter; 25MM Outer Race Width; 2 Seals; Ball Bearing; ABEC 1   ISO P0; No Filling Slot; No Snap Ring; Silicon Nitride Rolling Element   Electrical Insulated Internal Special
Other Features	Deep Groove   NBR Seal   Hybrid Silicon Nitride Rolling Element   WT Standard Grease
Category	Single Row Ball Bearing
UNSPSC	31171504
Harmonized Tariff Code	8482.10.50.68
Noun	Bearing
Keyword String	Ball
Manufacturer URL	<a href="http://www.skf.com">http://www.skf.com</a>
Manufacturer Item Number	6309-2RS1TN9/HC5C3W T
Weight / LBS	0.77



## BEARING CORP.OF AMERICA

Outside Diameter	3.937 Inch   100 Millimeter
Bore	1.772 Inch   45 Millimeter
Inner Race Width	0 Inch   0 Millimeter
Outer Race Width	0.984 Inch   25 Millimeter
$d_2$	54 mm
$D_2$	86.7 mm
$r_{1,2}$ min.	1.5 mm
$d_a$ min.	54 mm
$d_a$ max.	62.1 mm
$D_a$ max.	91 mm
$r_a$ max.	1.5 mm
Basic dynamic load rating C	55.3 kN
Basic static load rating $C_0$	31.5 kN
Fatigue load limit $P_u$	1.34 kN
Calculation factor $k_r$	0.025
Calculation factor $f_0$	13
Mass bearing	0.15 kg