

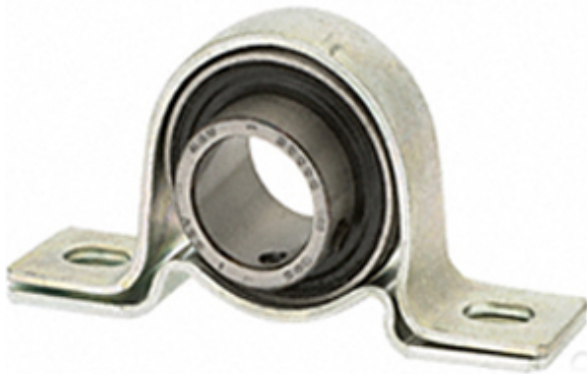

BEARING CORP.OF AMERICA

1.438 Inch | 36.525 Millimeter x 1.531 Inch | 38.9 Millimeter x 1.563 Inch | 39.7 Millimeter DODGE P2B-SLX-107 Pillow Block Bearings



Bearing No. P2B-SLX-107

P2B-SLX-107 Bearing 2D drawings and 3D CAD models

Category	Pillow Block Bearings
Inventory	0.0
Manufacturer Name	ABB MOTORS AND MECHANICAL INC
Minimum Buy Quantity	N/A
Weight	0.817
EAN	0782475762163
Product Group	M06110
Number of Mounting Holes	2
Mounting Method	Eccentric Collar
Housing Style	2 Bolt Pillow Block
Rolling Element	Ball Bearing
Housing Material	Stamped Steel
Expansion / Non-expansion	Non-expansion
Mounting Bolts	1/2 Inch
Relubricatable	Yes
Seals	Single Lip Contact
Housing Configuration	1 Piece Solid
Inch - Metric	Inch
Other Features	Single Row Light Duty Narrow Inner Race
Long Description	2 Bolt Pillow Block; 1-7/16" Bore; 1-9/16" Base to Center Height; Eccentric Collar Mount; Ball Bearing; Relubricatable; Stamped Steel; Single Lip Contact;



BEARING CORP.OF AMERICA

	Non-expansion
Category	Pillow Block
UNSPSC	31171511
Harmonized Tariff Code	8483.20.40.40
Noun	Bearing
Keyword String	Pillow Block
Manufacturer URL	http://www.dodge-pt.com
Manufacturer Item Number	P2B-SLX-107
Manufacturer Internal Number	128185
Weight / LBS	1.48
Nominal Bolt Center to Center	4.3 Inch 108 Millimeter
D	1.531 Inch 38.9 Millimeter
d	1.438 Inch 36.525 Millimeter
B	1.563 Inch 39.7 Millimeter
Actual Bolt Center to Center	4.3 Inch 109.2 Millimeter
Bolt Spacing Minimum	0 Inch 0 Millimeter
Bolt Spacing Maximum	0 Inch 0 Millimeter